

Silentbloky

Přezka a ocel / nerezová ocel

STANDARDNÍ PROVEDENÍ

- **DVA.5:** pouzdro se slepým závitovým otvorem a základová deska z leštěné pozinkované nerezové oceli, těleso tlumící vibrace z přírodní pryže NR, černá barva, tvrdost 40, 55, 70 s tolerancí ± 5 Shore A.
- **DVA.5-SST:** pouzdro se slepým závitovým otvorem a základová deska z nerezové oceli AISI 304, těleso tlumící vibrace z přírodní pryže NR, černá barva, tvrdost 55 s tolerancí ± 5 Shore A.

VLASTNOSTI A POUŽITÍ

Silentbloky byly navrženy k tlumení vibrací, nárazů a hluku vyvolaných pohybujícími se tělesy nebo vibracemi nevyvážených předmětů, strojů a zařízení, které mohou způsobit:

- špatnou funkci a snížení životnosti stroje nebo dalšího stroje v jeho blízkosti
- poškození zdraví
- hluk

Zátěžové diagramy pro jednotlivé silentbloky jsou k dispozici na vyžádání.

Další informace v kapitole: Technická data a pokyny pro výběr (viz. strana -).

SPECIÁLNÍ PROVEDENÍ NA VYŽÁDÁNÍ

Přírodní pryž NR, tvrdost 40, 70 s tolerancí ± 5 Shore A pro provedení se základnou z nerezové oceli AISI 304.



* Doplníte označení o požadovanou tvrdost pryže:
40, 55 nebo 70 ± Shore A

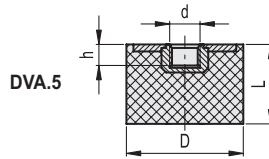

| Označení | D | L | d | h | △ | Tvrdost 40 Shore A | | | | Tvrdost 55 Shore A | | | | Tvrdost 70 Shore A | | | |
|--------------------|-----|----|-----|----|------|--------------------|-------------------|--------------------|---------------|--------------------|-------------------|--------------------|---------------|--------------------|-------------------|--------------------|---------------|
| | | | | | | Kód | Max. zatížení [N] | Max. stlačení [mm] | Tuhost [N/mm] | Kód | Max. zatížení [N] | Max. stlačení [mm] | Tuhost [N/mm] | Kód | Max. zatížení [N] | Max. stlačení [mm] | Tuhost [N/mm] |
| DVA.5-8-8-M3.* | 8 | 8 | M3 | 3 | 1 | 415691 | 34 | 2 | 17 | 413029 | 55 | 2 | 28 | 418391 | 141 | 2 | 71 |
| DVA.5-8-13-M3.* | 8 | 13 | M3 | 3 | 2 | 415693 | 33 | 3 | 10 | 413030 | 52 | 3 | 16 | 418393 | 133 | 3 | 41 |
| DVA.5-10-10-M4.* | 10 | 10 | M4 | 4 | 2 | 415701 | 54 | 3 | 21 | 413031 | 88 | 3 | 35 | 418401 | 217 | 3 | 87 |
| DVA.5-10-15-M4.* | 10 | 15 | M4 | 4 | 2 | 415703 | 69 | 4 | 18 | 413033 | 92 | 4 | 25 | 418403 | 175 | 4 | 47 |
| DVA.5-15-15-M4.* | 15 | 15 | M4 | 4 | 5 | 415711 | 141 | 4 | 38 | 413041 | 259 | 4 | 69 | 418411 | 384 | 4 | 102 |
| DVA.5-15-20-M4.* | 15 | 20 | M4 | 4 | 6 | 415721 | 134 | 5 | 27 | 413051 | 223 | 5 | 45 | 418421 | 590 | 5 | 118 |
| DVA.5-20-15-M6.* | 20 | 15 | M6 | 6 | 10 | 415731 | 289 | 4 | 77 | 413061 | 468 | 4 | 125 | 418431 | 704 | 4 | 188 |
| DVA.5-20-20-M6.* | 20 | 20 | M6 | 6 | 11 | 415741 | 258 | 5 | 52 | 413071 | 367 | 5 | 73 | 418441 | 809 | 5 | 162 |
| DVA.5-20-25-M6.* | 20 | 25 | M6 | 6 | 13 | 415751 | 250 | 6 | 40 | 413081 | 437 | 6 | 70 | 418451 | 750 | 6 | 120 |
| DVA.5-25-15-M6.* | 25 | 15 | M6 | 6 | 16 | 415761 | 485 | 4 | 129 | 413091 | 797 | 4 | 213 | 418461 | 1627 | 4 | 434 |
| DVA.5-25-20-M6.* | 25 | 20 | M6 | 6 | 20 | 415771 | 416 | 5 | 83 | 413101 | 581 | 5 | 116 | 418471 | 1382 | 5 | 276 |
| DVA.5-25-30-M6.* | 25 | 30 | M6 | 6 | 21 | 415781 | 290 | 8 | 39 | 413106 | 591 | 8 | 79 | 418481 | 1186 | 8 | 158 |
| DVA.5-30-15-M8.* | 30 | 15 | M8 | 8 | 23 | 415791 | 746 | 3 | 249 | 413111 | 1023 | 3 | 341 | 418491 | 2610 | 3 | 870 |
| DVA.5-30-17-M8.* | 30 | 17 | M8 | 8 | 25 | 415801 | 772 | 3 | 257 | 413121 | 1275 | 3 | 425 | 418501 | 2447 | 3 | 816 |
| DVA.5-30-20-M8.* | 30 | 20 | M8 | 8 | 27 | 415811 | 567 | 5 | 113 | 413141 | 1014 | 5 | 203 | 418511 | 1878 | 5 | 376 |
| DVA.5-30-30-M8.* | 30 | 30 | M8 | 8 | 34 | 415821 | 601 | 8 | 80 | 413146 | 776 | 8 | 103 | 418521 | 1616 | 8 | 215 |
| DVA.5-30-40-M8.* | 30 | 40 | M8 | 8 | 43 | 415823 | 550 | 10 | 55 | 413148 | 780 | 10 | 78 | 418523 | 1785 | 10 | 179 |
| DVA.5-40-20-M8.* | 40 | 20 | M8 | 8 | 45 | 415831 | 1200 | 5 | 240 | 413151 | 2500 | 5 | 500 | 418531 | 4750 | 5 | 950 |
| DVA.5-40-30-M8.* | 40 | 30 | M8 | 8 | 65 | 415841 | 1140 | 8 | 152 | 413161 | 1480 | 8 | 197 | 418541 | 2830 | 8 | 377 |
| DVA.5-40-40-M8.* | 40 | 40 | M8 | 8 | 75 | 415851 | 995 | 10 | 100 | 413171 | 1403 | 10 | 140 | 418551 | 3150 | 10 | 315 |
| DVA.5-40-50-M8.* | 40 | 50 | M8 | 8 | 90 | 415853 | 1005 | 13 | 80 | 413173 | 1397 | 13 | 112 | 418553 | 2382 | 13 | 191 |
| DVA.5-50-20-M10.* | 50 | 20 | M10 | 10 | 77 | 415861 | 2680 | 5 | 536 | 413181 | 3460 | 5 | 692 | 418561 | 7450 | 5 | 1490 |
| DVA.5-50-30-M10.* | 50 | 30 | M10 | 10 | 100 | 415871 | 1820 | 8 | 243 | 413183 | 2520 | 8 | 336 | 418571 | 5420 | 8 | 723 |
| DVA.5-50-40-M10.* | 50 | 40 | M10 | 10 | 115 | 415881 | 1430 | 10 | 143 | 413186 | 2760 | 10 | 276 | 418581 | 4950 | 10 | 495 |
| DVA.5-60-30-M10.* | 60 | 30 | M10 | 10 | 141 | 415891 | 2800 | 8 | 373 | 413191 | 4350 | 8 | 580 | 418591 | 7500 | 8 | 1000 |
| DVA.5-60-40-M10.* | 60 | 40 | M10 | 10 | 170 | 415895 | 2600 | 10 | 260 | 413192 | 3540 | 10 | 354 | 418595 | 4640 | 10 | 464 |
| DVA.5-60-50-M10.* | 60 | 50 | M10 | 10 | 205 | 415901 | 2900 | 13 | 232 | 413193 | 4370 | 13 | 350 | 418601 | 9500 | 13 | 760 |
| DVA.5-70-30-M10.* | 70 | 30 | M10 | 10 | 195 | 415907 | 4930 | 8 | 657 | 413195 | 7170 | 8 | 956 | 418607 | 13070 | 8 | 1743 |
| DVA.5-70-40-M10.* | 70 | 40 | M10 | 10 | 255 | 415911 | 3850 | 10 | 385 | 413196 | 6280 | 10 | 628 | 418611 | 15280 | 10 | 1528 |
| DVA.5-70-45-M10.* | 70 | 45 | M10 | 10 | 275 | 415921 | 3700 | 11 | 329 | 413201 | 6750 | 11 | 600 | 418621 | 8800 | 11 | 782 |
| DVA.5-70-55-M10.* | 70 | 55 | M10 | 10 | 341 | 415931 | 3320 | 14 | 241 | 413211 | 5770 | 14 | 420 | 418631 | 9510 | 14 | 692 |
| DVA.5-75-25-M12.* | 75 | 25 | M12 | 12 | 205 | 415941 | 6560 | 5 | 1312 | 413221 | 9660 | 5 | 1932 | 418641 | 20780 | 5 | 4156 |
| DVA.5-75-30-M12.* | 75 | 30 | M12 | 12 | 210 | 415951 | 5400 | 8 | 720 | 413226 | 8700 | 8 | 1160 | 418651 | 15400 | 8 | 2053 |
| DVA.5-75-40-M12.* | 75 | 40 | M12 | 12 | 290 | 415961 | 5010 | 10 | 501 | 413231 | 6680 | 10 | 668 | 418661 | 9170 | 10 | 917 |
| DVA.5-75-50-M12.* | 75 | 50 | M12 | 12 | 345 | 415971 | 3970 | 13 | 318 | 413241 | 5570 | 13 | 446 | 418671 | 13550 | 13 | 1084 |
| DVA.5-100-40-M16.* | 100 | 40 | M16 | 16 | 485 | 415981 | 9430 | 10 | 943 | 413261 | 12110 | 10 | 1211 | 418681 | 24190 | 10 | 2419 |
| DVA.5-100-50-M16.* | 100 | 50 | M16 | 16 | 580 | 415991 | 8320 | 13 | 666 | 413281 | 14040 | 13 | 1123 | 418691 | 22900 | 13 | 1832 |
| DVA.5-100-60-M16.* | 100 | 60 | M16 | 16 | 720 | 416001 | 7440 | 15 | 496 | 413291 | 12950 | 15 | 863 | 418701 | 21450 | 15 | 1430 |
| DVA.5-125-55-M16.* | 125 | 55 | M16 | 16 | 1050 | 416021 | 21217 | 14 | 1543 | 413321 | 23790 | 13 | 1809 | 418721 | 23751 | 11 | 2102 |
| DVA.5-125-75-M16.* | 125 | 75 | M16 | 16 | 1212 | 416031 | 18723 | 19 | 999 | 413331 | 22314 | 19 | 1190 | 418731 | 25000 | 18 | 1420 |



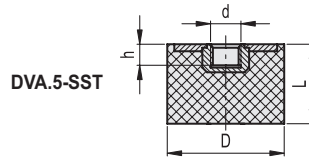

STAINLESS STEEL

DVA.5 - 10 - 10 - SST - M4 - 55
 D L Stainless steel d Shore A

| Označení | D | L | d | h | Tvrdost 40 Shore A | | | | Tvrdost 55 Shore A | | | | Tvrdost 70 Shore A | | | |
|-------------------------|-----|----|-----|----|--------------------|-------------------|--------------------|---------------|--------------------|-------------------|--------------------|---------------|--------------------|-------------------|--------------------|---------------|
| | | | | | Kód | Max. zatížení [N] | Max. stlačení [mm] | Tuhost [N/mm] | Kód | Max. zatížení [N] | Max. stlačení [mm] | Tuhost [N/mm] | Kód | Max. zatížení [N] | Max. stlačení [mm] | Tuhost [N/mm] |
| DVA.5-8-8-SST-M3-55 | 8 | 8 | M3 | 3 | 1 | 34 | 2 | 17 | 410398 | 55 | 2 | 28 | 141 | 2 | 71 | |
| DVA.5-8-13-SST-M3-55 | 8 | 13 | M3 | 3 | 2 | 33 | 3 | 10 | 410399 | 52 | 3 | 16 | 133 | 3 | 41 | |
| DVA.5-10-10-SST-M4-55 | 10 | 10 | M4 | 4 | 2 | 54 | 3 | 21 | 410401 | 88 | 3 | 35 | 217 | 3 | 87 | |
| DVA.5-10-15-SST-M4-55 | 10 | 15 | M4 | 4 | 2 | 69 | 4 | 18 | 410403 | 92 | 4 | 25 | 175 | 4 | 47 | |
| DVA.5-15-15-SST-M4-55 | 15 | 15 | M4 | 4 | 5 | 141 | 4 | 38 | 410405 | 259 | 4 | 69 | 384 | 4 | 102 | |
| DVA.5-15-20-SST-M4-55 | 15 | 20 | M4 | 4 | 6 | 134 | 5 | 27 | 410407 | 223 | 5 | 45 | 590 | 5 | 118 | |
| DVA.5-20-15-SST-M6-55 | 20 | 15 | M6 | 6 | 10 | 289 | 4 | 77 | 410413 | 468 | 4 | 125 | 704 | 4 | 188 | |
| DVA.5-20-20-SST-M6-55 | 20 | 20 | M6 | 6 | 11 | 258 | 5 | 52 | 410415 | 367 | 5 | 73 | 809 | 5 | 162 | |
| DVA.5-20-25-SST-M6-55 | 20 | 25 | M6 | 6 | 13 | 250 | 6 | 40 | 410417 | 437 | 6 | 70 | 750 | 6 | 120 | |
| DVA.5-25-15-SST-M6-55 | 25 | 15 | M6 | 6 | 16 | 485 | 4 | 129 | 410421 | 797 | 4 | 213 | 1627 | 4 | 434 | |
| DVA.5-25-20-SST-M6-55 | 25 | 20 | M6 | 6 | 20 | 416 | 5 | 83 | 410425 | 581 | 5 | 116 | 1382 | 5 | 276 | |
| DVA.5-25-30-SST-M6-55 | 25 | 30 | M6 | 6 | 21 | 290 | 8 | 39 | 410427 | 591 | 8 | 79 | 1186 | 8 | 158 | |
| DVA.5-30-15-SST-M8-55 | 30 | 15 | M8 | 8 | 23 | 746 | 3 | 249 | 410431 | 1023 | 3 | 341 | 2610 | 3 | 870 | |
| DVA.5-30-17-SST-M8-55 | 30 | 17 | M8 | 8 | 25 | 772 | 3 | 257 | 410433 | 1275 | 3 | 425 | 2447 | 3 | 816 | |
| DVA.5-30-20-SST-M8-55 | 30 | 20 | M8 | 8 | 27 | 567 | 5 | 113 | 410435 | 1014 | 5 | 203 | 1878 | 5 | 376 | |
| DVA.5-30-30-SST-M8-55 | 30 | 30 | M8 | 8 | 34 | 601 | 8 | 80 | 410437 | 776 | 8 | 103 | 1616 | 8 | 215 | |
| DVA.5-30-40-SST-M8-55 | 30 | 40 | M8 | 8 | 43 | 550 | 10 | 55 | 410439 | 780 | 10 | 78 | 1785 | 10 | 179 | |
| DVA.5-40-20-SST-M8-55 | 40 | 20 | M8 | 8 | 45 | 1200 | 5 | 240 | 410441 | 2500 | 5 | 500 | 4750 | 5 | 950 | |
| DVA.5-40-30-SST-M8-55 | 40 | 30 | M8 | 8 | 65 | 1140 | 8 | 152 | 410443 | 1480 | 8 | 197 | 2830 | 8 | 377 | |
| DVA.5-40-40-SST-M8-55 | 40 | 40 | M8 | 8 | 75 | 995 | 10 | 100 | 410445 | 1403 | 10 | 140 | 3150 | 10 | 315 | |
| DVA.5-40-50-SST-M8-55 | 40 | 50 | M8 | 8 | 90 | 1005 | 13 | 80 | 410447 | 1397 | 13 | 112 | 2382 | 13 | 191 | |
| DVA.5-50-20-SST-M10-55 | 50 | 20 | M10 | 10 | 77 | 2680 | 5 | 536 | 410451 | 3460 | 5 | 692 | 7450 | 5 | 1490 | |
| DVA.5-50-30-SST-M10-55 | 50 | 30 | M10 | 10 | 100 | 1820 | 8 | 243 | 410453 | 2520 | 8 | 336 | 5420 | 8 | 723 | |
| DVA.5-50-40-SST-M10-55 | 50 | 40 | M10 | 10 | 115 | 1430 | 10 | 143 | 410455 | 2760 | 10 | 276 | 4950 | 10 | 995 | |
| DVA.5-60-30-SST-M10-55 | 60 | 30 | M10 | 10 | 141 | 2800 | 8 | 373 | 410461 | 4350 | 8 | 580 | 7500 | 8 | 1000 | |
| DVA.5-60-40-SST-M10-55 | 60 | 40 | M10 | 10 | 170 | 2600 | 10 | 260 | 410462 | 3540 | 10 | 354 | 4640 | 10 | 464 | |
| DVA.5-60-50-SST-M10-55 | 60 | 50 | M10 | 10 | 205 | 2900 | 13 | 232 | 410463 | 4370 | 13 | 350 | 9500 | 13 | 760 | |
| DVA.5-70-30-SST-M10-55 | 70 | 30 | M10 | 10 | 195 | 4930 | 8 | 657 | 410470 | 7170 | 8 | 956 | 13070 | 8 | 1743 | |
| DVA.5-70-40-SST-M10-55 | 70 | 40 | M10 | 10 | 255 | 3850 | 10 | 385 | 410471 | 6280 | 10 | 628 | 15280 | 10 | 1528 | |
| DVA.5-70-45-SST-M10-55 | 70 | 45 | M10 | 10 | 275 | 3700 | 11 | 329 | 410473 | 6750 | 11 | 600 | 8800 | 11 | 782 | |
| DVA.5-70-55-SST-M10-55 | 70 | 55 | M10 | 10 | 341 | 3320 | 14 | 241 | 410475 | 5770 | 14 | 420 | 9510 | 14 | 692 | |
| DVA.5-75-25-SST-M12-55 | 75 | 25 | M12 | 12 | 205 | 6560 | 5 | 1312 | 410481 | 9660 | 5 | 1932 | 20780 | 5 | 4156 | |
| DVA.5-75-30-SST-M12-55 | 75 | 30 | M12 | 12 | 210 | 5400 | 8 | 720 | 410483 | 8700 | 8 | 1160 | 15400 | 8 | 2053 | |
| DVA.5-75-40-SST-M12-55 | 75 | 40 | M12 | 12 | 290 | 5010 | 10 | 501 | 410485 | 6680 | 10 | 668 | 9170 | 10 | 917 | |
| DVA.5-75-50-SST-M12-55 | 75 | 50 | M12 | 12 | 345 | 3970 | 13 | 318 | 410487 | 5570 | 13 | 446 | 13550 | 13 | 1084 | |
| DVA.5-100-40-SST-M16-55 | 100 | 40 | M16 | 16 | 485 | 9430 | 10 | 943 | 410491 | 12110 | 10 | 1211 | 24190 | 10 | 2419 | |
| DVA.5-100-50-SST-M16-55 | 100 | 50 | M16 | 16 | 580 | 8320 | 13 | 666 | 410493 | 14040 | 13 | 1123 | 22900 | 13 | 1832 | |
| DVA.5-100-60-SST-M16-55 | 100 | 60 | M16 | 16 | 720 | 7440 | 15 | 496 | 410495 | 12950 | 15 | 863 | 21450 | 15 | 1430 | |
| DVA.5-125-55-SST-M16-55 | 125 | 55 | M16 | 16 | 1050 | 21217 | 14 | 1543 | 410496 | 23790 | 13 | 1809 | 23751 | 11 | 2102 | |
| DVA.5-125-75-SST-M16-55 | 125 | 75 | M16 | 16 | 1212 | 18723 | 19 | 999 | 410497 | 22314 | 19 | 1190 | 25000 | 18 | 1420 | |

Antivibrační elementy 21